

BARRES RECTANGULAIRES ET RONDES

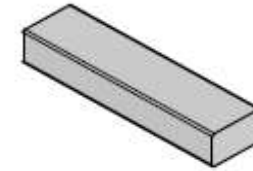

Unités anglaises : Pouces, livres

| Hauteur (A) | Largeur (B) | Rayon de pointe (R) | Poids/PI | Hauteur (A) | Largeur (B) | Rayon de pointe (R) | Poids/PI | Hauteur (A) | Largeur (B) | Rayon de pointe (R) | Poids/PI |
|-------------|-------------|---------------------|----------|-------------|-------------|---------------------|----------|-------------|-------------|---------------------|----------|
| 0.062 | 1.000 | 0.016 | 0.074 | 0.188 | 2.500 | 0.025 | 0.563 | 0.375 | 2.000 | 0.062 | 0.896 |
| 0.062 | 1.500 | 0.016 | 0.093 | 0.250 | 1.000 | 0.062 | 0.296 | 0.375 | 2.500 | 0.062 | 1.103 |
| 0.064 | 1.250 | 0.016 | 0.096 | 0.250 | 1.250 | 0.016 | 0.374 | 0.375 | 3.500 | 0.062 | 1.546 |
| 0.090 | 1.125 | 0.016 | 0.121 | 0.250 | 1.500 | 0.016 | 0.450 | 0.375 | 4.000 | 0.062 | 1.796 |
| 0.125 | 0.750 | 0.016 | 0.113 | 0.250 | 1.500 | 0.062 | 0.446 | 0.375 | 5.000 | 0.062 | 2.204 |
| 0.125 | 1.000 | 0.016 | 0.150 | 0.250 | 1.875 | 0.016 | 0.563 | 0.375 | 6.000 | 0.062 | 2.696 |
| 0.125 | 1.250 | 0.016 | 0.187 | 0.250 | 2.000 | 0.016 | 0.600 | 0.500 | 1.000 | 0.016 | 0.591 |
| 0.125 | 1.500 | 0.016 | 0.224 | 0.250 | 2.000 | 0.062 | 0.596 | 0.500 | 2.000 | 0.062 | 1.177 |
| 0.125 | 2.000 | 0.007 | 0.287 | 0.250 | 3.000 | 0.062 | 0.896 | 0.500 | 2.500 | 0.062 | 1.472 |
| 0.125 | 3.000 | 0.016 | 0.450 | 0.250 | 3.500 | 0.016 | 0.994 | 0.500 | 3.000 | 0.062 | 1.767 |
| 0.125 | 3.500 | 0.016 | 0.524 | 0.250 | 4.000 | 0.016 | 1.200 | 0.500 | 3.000 | FULL | 1.735 |
| 0.185 | 3.000 | 0.016 | 0.665 | 0.250 | 4.000 | 0.062 | 1.177 | 0.500 | 4.000 | 0.062 | 2.357 |
| 0.187 | 0.750 | 0.016 | 0.169 | 0.250 | 5.500 | 0.062 | 1.646 | 0.500 | 5.500 | 0.062 | 3.296 |
| 0.188 | 1.000 | 0.016 | 0.226 | 0.250 | 6.000 | 0.016 | 1.800 | 0.500 | 6.000 | 0.016 | 3.600 |
| 0.188 | 1.438 | 0.016 | 0.323 | 0.250 | 6.000 | FULL | 1.784 | 0.625 | 4.000 | 0.062 | 2.947 |
| 0.188 | 1.750 | 0.016 | 0.395 | 0.312 | 5.000 | 0.016 | 1.872 | 0.750 | 0.500 | 0.016 | 0.450 |
| 0.188 | 2.000 | 0.016 | 0.451 | 0.375 | 1.000 | 0.016 | 0.450 | 0.750 | 1.500 | 0.016 | 1.350 |
| 0.188 | 2.250 | 0.016 | 0.508 | 0.375 | 1.375 | FULL | 0.582 | 1.000 | 2.000 | 0.016 | 2.400 |
| 0.188 | 2.500 | 0.015 | 0.564 | 0.375 | 1.500 | 0.016 | 0.674 | 1.500 | 1.500 | 0.250 | 1.454 |

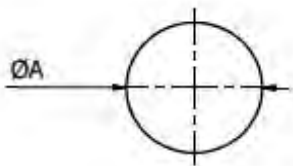

| Diamètre (A) | Poids/PI |
|--------------|----------|
| 0.500 | 0.235 |
| 1.000 | 0.943 |
| 2.000 | 3.768 |
| 2.500 | 5.770 |

